

Minature Camera model TBS-8.5

TOSHNIWAL SENSING DEVICES PVT. LTD.
 E-19/20, INDUSTRIAL ESTATE MAKHUPURA , AJMER-305002, INDIA
 TEL: +91-145-2695482 , FAX: +91-145-2695006
 CUSTOMER CARE: +91-9571897879
 E-MAIL: sales@tsdpl.com, WEBSITE: www.tsdpl.com

Resolution: 378,000 Pixels LED illumination

Small camera head measuring $\phi 8.5\text{mm}$ x length 26mm Illumination: Chip LED (6pcs) with ON/OFF switch on controller

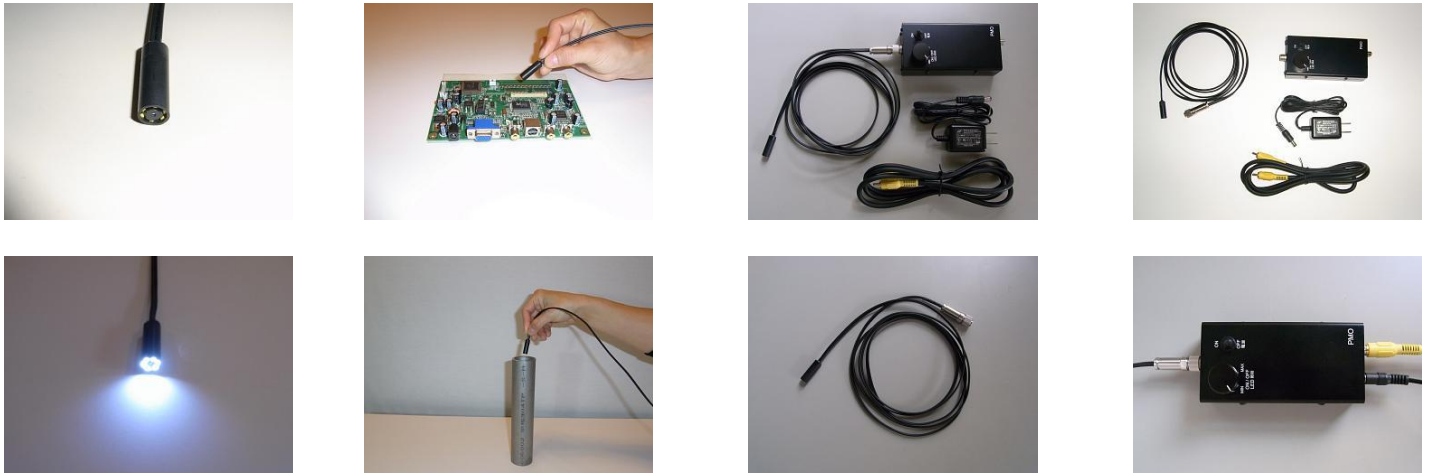

Fixed Focus : From 5cm $\sim\infty$, Standard cable length : 2m

Technical specifications

Sensor	CMOS	Cable length	Standard 2 meters
Picture output signal	NTSC composite video	Housing material	Camera ABS Resin Glass (TEMPAX, Window Part) Controller Aluminum (black alumite treatment)
Resolution	378,000 Pixels 720(H) \times 525(V)	Controller	Picture Output Jack : RCA Power in jack: 5VDC On/Off switch LED light intensity adjustment knob
Focus	Fixed focus from 5cm $\sim\infty$		
Infrared cut filter	Available		
Angle of view	64 $^{\circ}$ (Horizontal) 50 $^{\circ}$ (Vertical)		
Brightness	F = 2.8		
Working temperature	0 \sim 50 $^{\circ}$ C		
Supply Voltage	5V DC		
Power consumption	Maximum 650mW	Standard set	Camera head (1 pc) Cable (1 pc, 2m long) Controller (1 pc) Power adapter for 100/240V AC input/ 500VDC output (1 pc) Video cable)1 pc)
Sensitivity of Light	Min. Illumination 0.2Lux (F = 1.4)		
Illumination	Chip LED (6 pcs) Light up distance about 30cm		
Dimensions	Camera head $\phi 8.5\text{mm}$ x length 26mm Controller 120 (L) x 60 (W) x 30m (H)	Optional extension cable	3m, 5m or 10m, 15m, 30m, 50m or 100m long (in case of optional longer cable able size will be $\phi 3.5\text{mm}$, and camera head will be 8mm longer
Cable	$\phi 3.5\text{mm}$, 1.5C-2V coaxial compound cable		

<

Image Sample

>

<>



LED illumination inside a
Stainless steel p Pipe
Inner Diameter: 33mm Length 20cm



Bright Room (LED OFF)
12cm to the connector
40cm to the back wall



Well-lit Room (LED OFF)
Indoor Scenery
Subject distance 5-6m



3m : ¥12,600 (tax in)
5m : ¥18,900 (tax in)
10m : ¥27,300 (tax in)